

**Joint Meeting of the
Riverside Community College District Board of Trustees
and
Riverside Unified School District Board of Education**

Tuesday, May 29, 2018

6:00 PM

**Riverside City College, Hall of Fame
4800 Magnolia Avenue
Riverside, CA 92506**

Anyone who wishes to make a presentation to the Board on an agenda item is requested to please fill out a "REQUEST TO ADDRESS THE BOARD OF TRUSTEES" card, available from the Public Affairs Officer. However, the Board Chairperson will invite comments on specific agenda items during the meeting before final votes are taken. Please make sure that the Secretary of the Board has the correct spelling of your name and address to maintain proper records. Comments should be limited to five (5) minutes or less. (This time limit will be doubled for members of the public utilizing a translator to ensure the non-English speaker receives the same opportunity to directly address the Board, unless simultaneous translation equipment is used which allows the Board to hear the translation simultaneously.)

Anyone who requires a disability-related modification or accommodation in order to participate in any meeting should contact the Chancellor's Office at (951) 222-8801 and speak to an Executive Administrative Assistant as far in advance of the meeting as possible.

Any public records relating to an open session agenda item that is distributed within 72 hours prior to the meeting is available for public inspection at the Riverside Community College District Chancellor's Office, 3rd Floor, 3801 Market Street, Riverside, California, 92501 or online at www.rccd.edu/administration/board.

ORDER OF BUSINESS

Pledge of Allegiance

Roll Call

I. INTRODUCTION – RCCD BOARD OF TRUSTEES AND RUSD BOARD OF EDUCATION

II. COMMENTS FROM THE PUBLIC

Board invites comments from the public regarding any matters within the jurisdiction of the Board of Trustees. Due to the Ralph M. Brown Act, the Board cannot address or respond to comments made under Public Comment.

III. REPORTS/DISCUSSION

IV. DUAL ENROLLMENT

A presentation will be shared with the Board of Trustees from Riverside Unified School District and Riverside Community College District with information regarding the partnership for student success, college and career readiness, with regards to Dual Enrollment.

V. COLLEGE AND CAREER ACCESS PATHWAYS (CCAP)

A presentation will be shared with the Board of Trustees from Riverside Unified School District and Riverside Community College District with information regarding the partnership for student success, college and career readiness, with regards to College and Career Access Pathways (CCAP).

VI. MIDDLE COLLEGE

A presentation will be shared with the Board of Trustees from Riverside Unified School District and Riverside Community College District with information regarding the partnership for student success, college and career readiness, with regards to Middle College and dual enrollment.

VII. MEETING CONCLUSION

- a. Board Member's Comments
- b. Agenda Items for Future Meetings

VIII. ADJOURNMENT

Dual Enrollment

A Partnership for Student Success in College & Career

Presentation to the joint meeting of the Boards

May 29, 2018

RCCD | RIVERSIDE COMMUNITY
COLLEGE DISTRICT
MORENO VALLEY COLLEGE | NORCO COLLEGE | RIVERSIDE CITY COLLEGE



Overview

Ongoing

- Concurrent Enrollment
- Articulated Agreements
- RCC-RUSD MOU| 2015

Present

- CCAP| 2018

Future

- Middle College Vision

Articulation Agreements

21 Agreements in place
3 Agreements pending
Industry sectors

- Arts, Media and Entertainment
- Business
- Engineering
- Health Science and Medical Technology
- Information and Communication Technologies

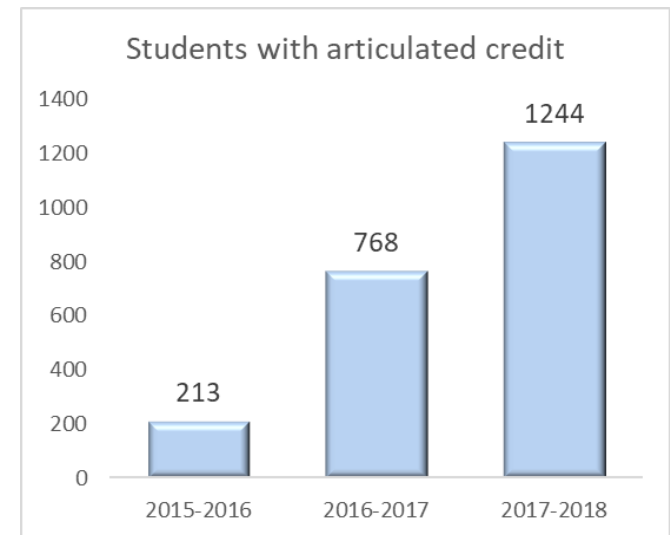
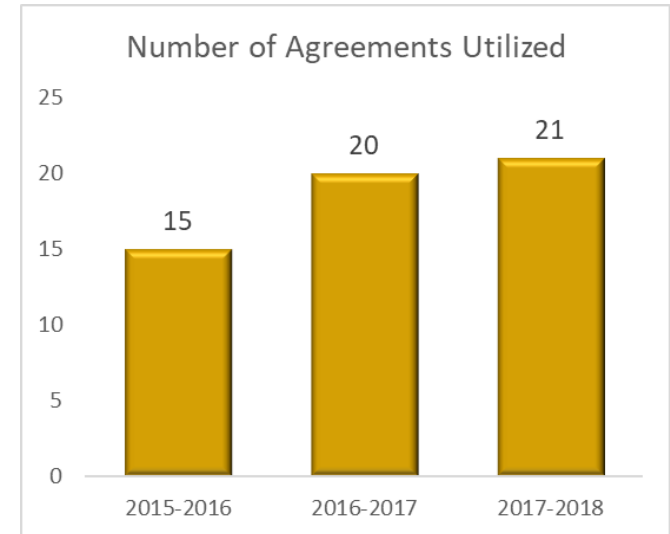

RCC-RUSD MOU

5 RUSD high school Course offerings

- Business
- Early Childhood Education
- Communication Studies
- Music Appreciation
- Pre-nursing success

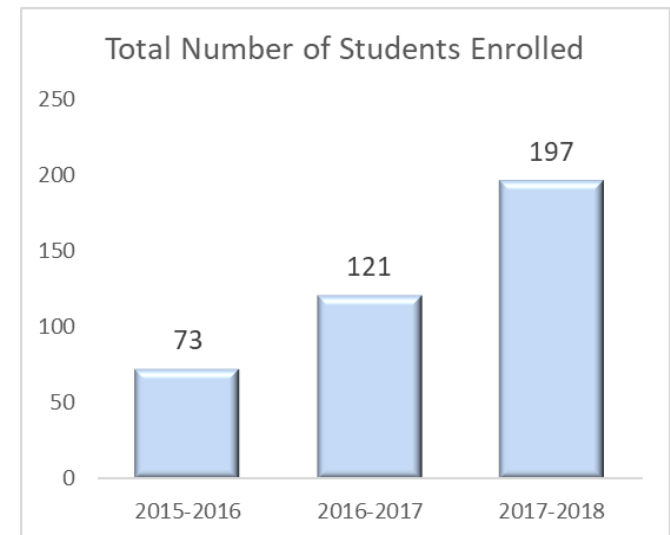
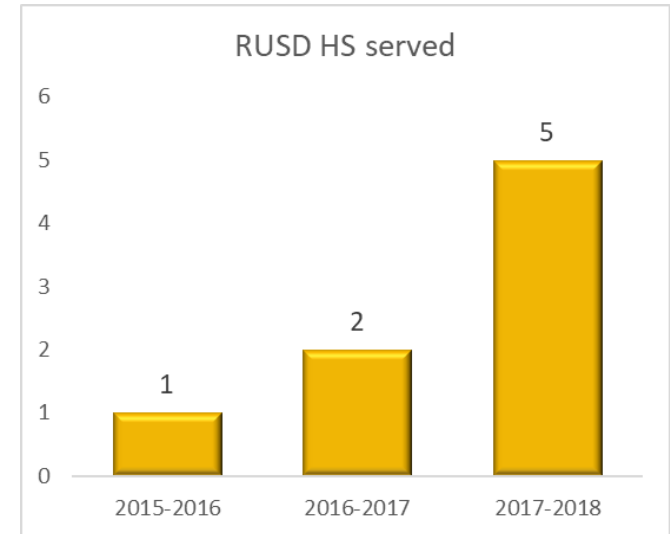

First-Time Freshmen Enrollment

RUSD-RCC Students

First Time Freshmen by Start Term

RUSD High School	Fall 2015	Fall 2016	Fall 2017
Abraham Lincoln Continuation	19	15	11
Arlington High	114	112	126
John W. North High	150	129	125
Martin Luther King Jr. High	207	241	210
Polytechnic High	218	221	180
Raincross High (Continuation)	5	7	6
Ramona High	184	134	145
Riverside STEM Academy	0	0	11
Summit View Independent Study	21	17	17
Total	918	876	831
<i>% of Total Incoming Freshmen</i>	<i>20.8%</i>	<i>20.1%</i>	<i>17.4%</i>

Fall 2017 RUSD Race / Ethnicity

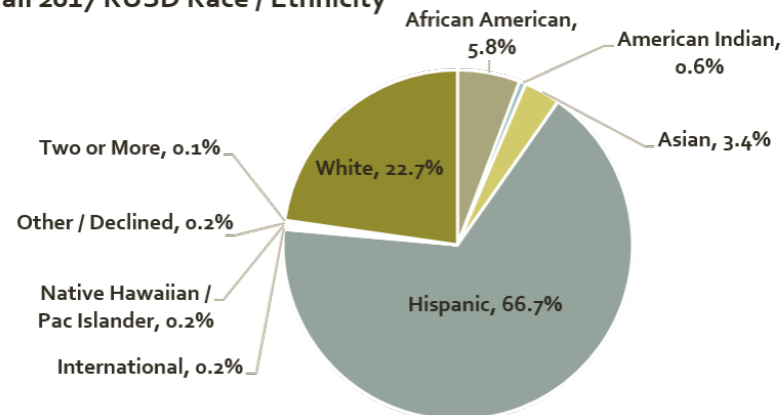

Initial Placement and Student Progress

RUSD-RCC Students

First-Time Freshmen Fall 2017 Placement in English and Math

English Placement	English Placement	Math Placement
College Level	48.0%	40.8%
1 Level Below	9.4%	16.6%
2 Levels Below	2.0%	8.3%
3+ Levels Below	1.6%	2.9%
No Score	39.0%	31.4%
Total	100.0%	100.0%

Student progress: percentage who pass Transfer-Level English or Transfer-Level Math within first year.

First-Time Freshmen from Fall 2011 through Fall 2015 (not including those who are skills-builders or enrolled in CTE certificate programs)

	% Passed English		% Passed Math	
	1st Semester	1st Year	1st Semester	1st Year
Abraham Lincoln Continuation	0.0%	37.5%	0.0%	0.0%
Arlington High	17.8%	56.9%	19.3%	54.2%
John W. North High	20.7%	63.3%	10.9%	39.9%
Martin Luther King Jr. High	27.9%	62.7%	19.8%	49.5%
Polytechnic High	27.2%	64.2%	17.9%	40.6%
Raincross High (Continuation)	18.2%	63.6%	0.0%	0.0%
Ramona High	21.3%	58.9%	18.9%	45.3%
Summit View Independent Study	18.5%	37.0%	0.0%	22.2%
Overall	24.0%	61.5%	17.3%	44.8%

Student Success

Degree and Certificate Awards for Fall 2011 through Fall 2013 First-Time Freshmen

	Assoc. of Arts	Assoc. of Science	Certificate	None (yet)	Total	% Degree/Cert
Abraham Lincoln Continuation	0	1	2	30	33	9.1%
Arlington High	37	13	10	232	292	20.5%
John W. North High	42	9	14	316	381	17.1%
Martin Luther King Jr. High	75	29	19	348	471	26.1%
Polytechnic High	80	18	18	376	492	23.6%
Raincross High (Continuation)	0	1	1	11	13	15.4%
Ramona High	30	8	19	255	312	18.3%
Summit View Independent Study	4	2	1	43	50	14.0%
Overall	268	81	84	1611	2044	21.2%

Transfer for Fall 2011 through Fall 2013 First-Time Freshmen

	UC System	CSU System	Out of State Public	Private	None (yet)	Total	% Transfer
Abraham Lincoln Continuation	0	0	0	2	31	33	6.1%
Arlington High	5	24	8	23	269	292	20.5%
John W. North High	17	29	14	22	359	381	21.5%
Martin Luther King Jr. High	40	69	22	42	429	471	36.7%
Polytechnic High	38	67	13	36	456	492	31.3%
Raincross High (Continuation)	0	0	0	1	12	13	7.7%
Ramona High	8	16	6	30	282	312	19.2%
Summit View Independent Study	3	2	0	2	48	50	14.0%
Overall	111	207	63	158	1886	2044	26.4%

The combination of students who have received a degree, certificate, and / or transferred by the number of years a student took to complete.

% Completion Overall	% Completion			Still Enrolled Fall 2017
	1-2 Years	1-3 Years	1-4 Years	
Abraham Lincoln Continuation	6.1%	9.1%	12.1%	6.1%
Arlington High	5.1%	12.0%	22.9%	15.8%
John W. North High	6.0%	13.6%	22.8%	15.2%
Martin Luther King Jr. High	9.8%	24.6%	39.5%	14.9%
Polytechnic High	7.9%	20.5%	33.9%	18.3%
Raincross High (Continuation)	0.0%	15.4%	23.1%	15.4%
Ramona High	5.4%	12.8%	21.5%	17.9%
Summit View Independent Study	0.0%	6.0%	18.0%	12.0%
Overall	6.9%	17.2%	28.9%	16.1%

College & Career Access Pathways

CCAP

College and Career Access Pathways

Purpose

Expanding dual enrollment for students who may not already be college bound or who are underrepresented in higher education

Goals

- Seamless pathways to community college for Career & Technical Education or for Transfer
- Improve high school graduation rates
- Improve college and career readiness

College and Career Access Pathways

Features

- Legal foundation | AB 288
- Courses offered on a Pathway
- Flexible options for scheduling
- Enrollment open to high school students only
- Credits earned for high school graduation & college
- Apportionment
- Impact for students

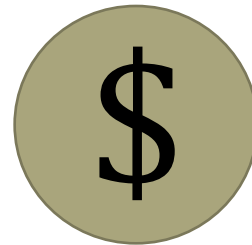

Saving time

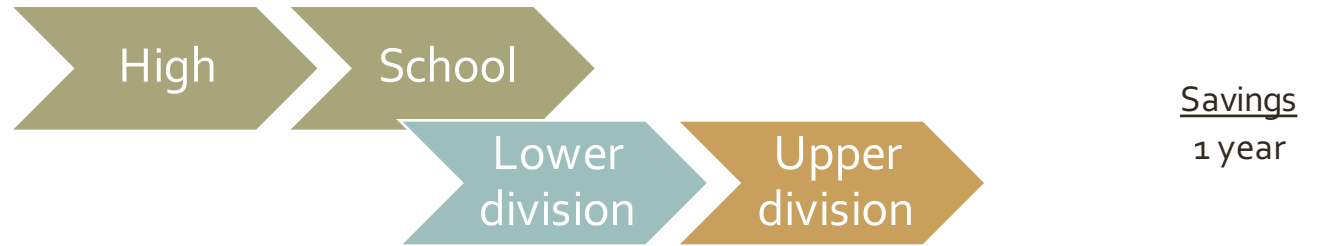



Saving money

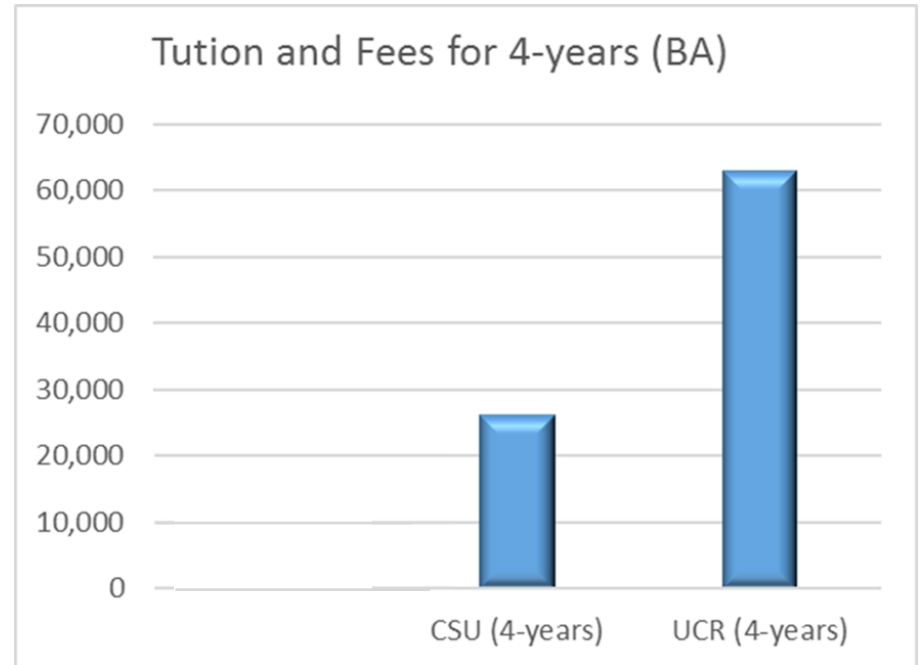

Saving money



Tuition and Fees for 4-years (BA)

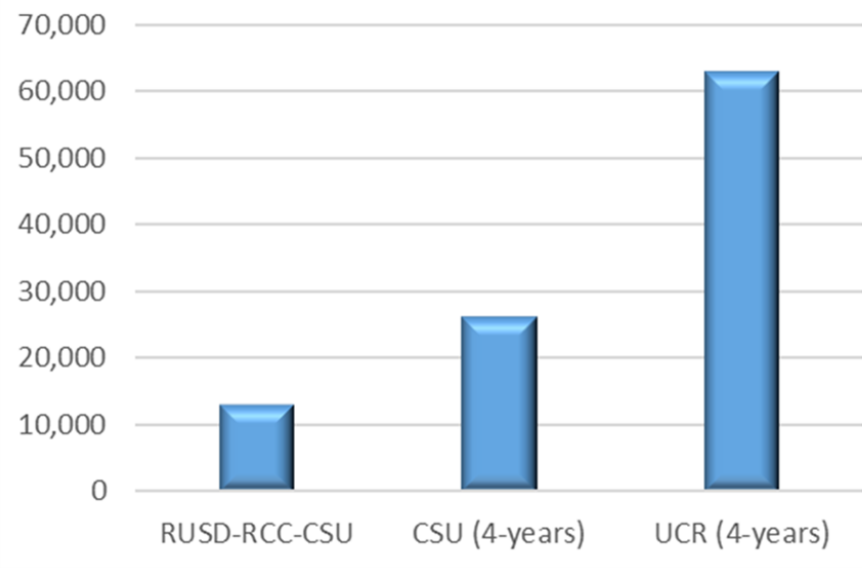

College and Career Access Pathways

Student Support - Outreach

- RCC Senior Nights
- Application workshops at high schools
- Information source

College and Career Access Pathways

Student Support - Admissions & Records

- RCC transcripts
- Application and enrollment issues
- Unified school district invoicing
- High school presence
 - CCAP Applications
 - Adding/Dropping CCAP Classes
 - General Enrollment Support
 - Information source
 - RCC Photo IDs
 - Support transition from CCAP enrollment to “traditional” enrollment at RCC

College and Career Access Pathways

Student Academic Support

- Counseling
- Educational advising
- Tutoring
- Peer mentors
- Library access
- Faculty Advising

CCAP Pathways

Riverside City College CCAP Pathways

By semester by grade level

	Grade 10			Grade 11			Grade 12			Total Units			
	Fall	Units	Spring	Units	Fall	Units	Spring	Units	Fall		Units	Spring	Units
Liberal Arts General Education Pathway													
	THE-3 <i>Introduction to the Theater</i>	3	MUS-89 <i>Music of Multicultural America</i>	3	BIO-36 <i>Environmental Science</i>	3	COM-9 <i>Interpersonal Communication</i>	3	MAT-37 <i>Algebra for Statistics</i>	6	MAT-12 <i>Statistics</i>	4	
			GUI-48 <i>College Success Strategies</i>	2			SPA-1 <i>Spanish I</i>	5	SPA-2 <i>Spanish II</i>	5			
Total Units		3		5		3		8		11		4	34
Business Administration Pathway													
	GUI-48 <i>College Success Strategies</i>	2	BUS-10 <i>Introduction to Business</i>	3	BUS-18A <i>Business Law I</i>	3	BUS-20 <i>Business Mathematics</i>	3	GUI-45 <i>Introduction to College</i>	1	POL-1 <i>American Politics</i>	3	
							BUS-22 <i>Management Communications</i>	3	ENG-50 <i>Basic English Composition</i>	4	ENG-1A <i>English Composition</i>	4	
Total Units		2		3		3		6		5		7	26
Pathway to Law / Paralegal Studies													
	GUI-48 <i>College Success</i>	2	PAL-10 <i>Introduction to Paralegal Studies</i>	3	BUS-18A <i>Business Law I</i>	3	BUS-18B <i>Business Law II</i>	3	GUI-45 <i>Introduction to College</i>	1	POL-1 <i>American Politics</i>	3	
							PAL-14 <i>Legal Ethics</i>	3	ENG-50 <i>Basic English Composition</i>	4	ENG-1A <i>English Composition</i>	4	
Total Units		2		3		3		6		5		7	26

Alignment with RCC Guided Pathways

College and Career Access Pathways



Visual, Performing, & Creative Arts

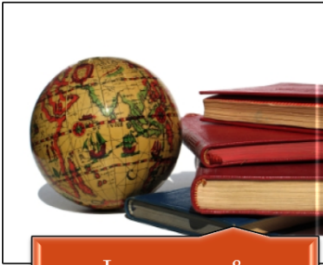

Languages & Humanities



Social & Behavioral Sciences



STEM



Advanced Technical Trades



Business & Information Systems and Technology



Health-Related Sciences



Education & Teacher Preparation

College and Career Access Pathways

Timeline

RUSD HS	Pathway
Arlington	Liberal Arts General Education
	Business Administration
J. W. North	Liberal Arts General Education
M L King	Liberal Arts General Education
Ramona	Liberal Arts General Education
	Business Administration
Riverside Poly	Business Administration
	Pathway to Law / Paralegal

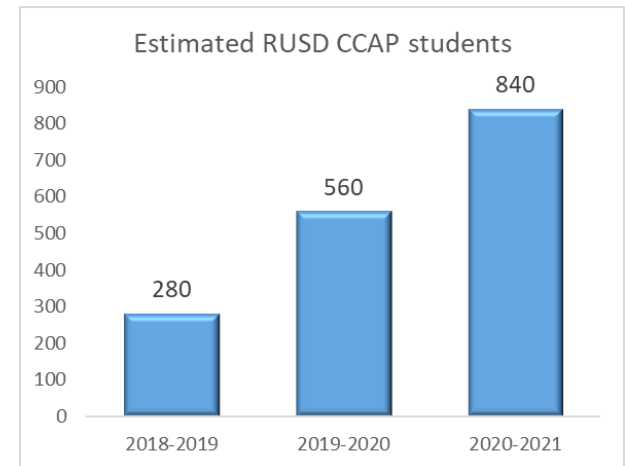

Cohort #1

- 2021 RUSD High School Graduation
- 2022 RCC Graduation
- 2024 CSU/UC Graduation

Middle College High School

Future

Middle College High School Vision

Focus on STEM and Career & Technical programs

May include

- Basic Sciences (math, biology, chemistry, physics, geology)
- Computer Science
- Cybersecurity
- Pre-nursing
- Automotive
- Cosmetology
- Culinary
- HVAC
- Welding

Middle College High School Update

June, 2016

- Mr. Tom Hunt
- Mr. Brent Lee
- Chancellor Burke
- President Virginia Blumenthal

January 19, 2017 Meeting

- Dr. Wolde-Ab Isaac
- Dr. Susan Mills
- Dr. FeRita Carter
- Dr. David Hansen
- Lynn Carmen-Day
- Mays Kakish

April 19, 2017 Meeting

- Dr. FeRita Carter
- Mays Kakish

Middle College High School Update

August 22, 2017 Walk Through with RUSD & RCC

- Dr. FeRita Carter
- Chip West
- Dr. Susan Mills
- Dr. Carol Farrar
- Mays Kakish

March 28, 2018 Meeting

- Dr. FeRita Carter
- Mays Kakish

May 3, 2018 Meeting

discuss RCCD and RUSD joint Board of Trustees meeting

- Dr. Wolde-Ab Isaac
- Dr. David Hansen
- Dr. Ryan Lewis
- Mays Kakish

Existing Central MS

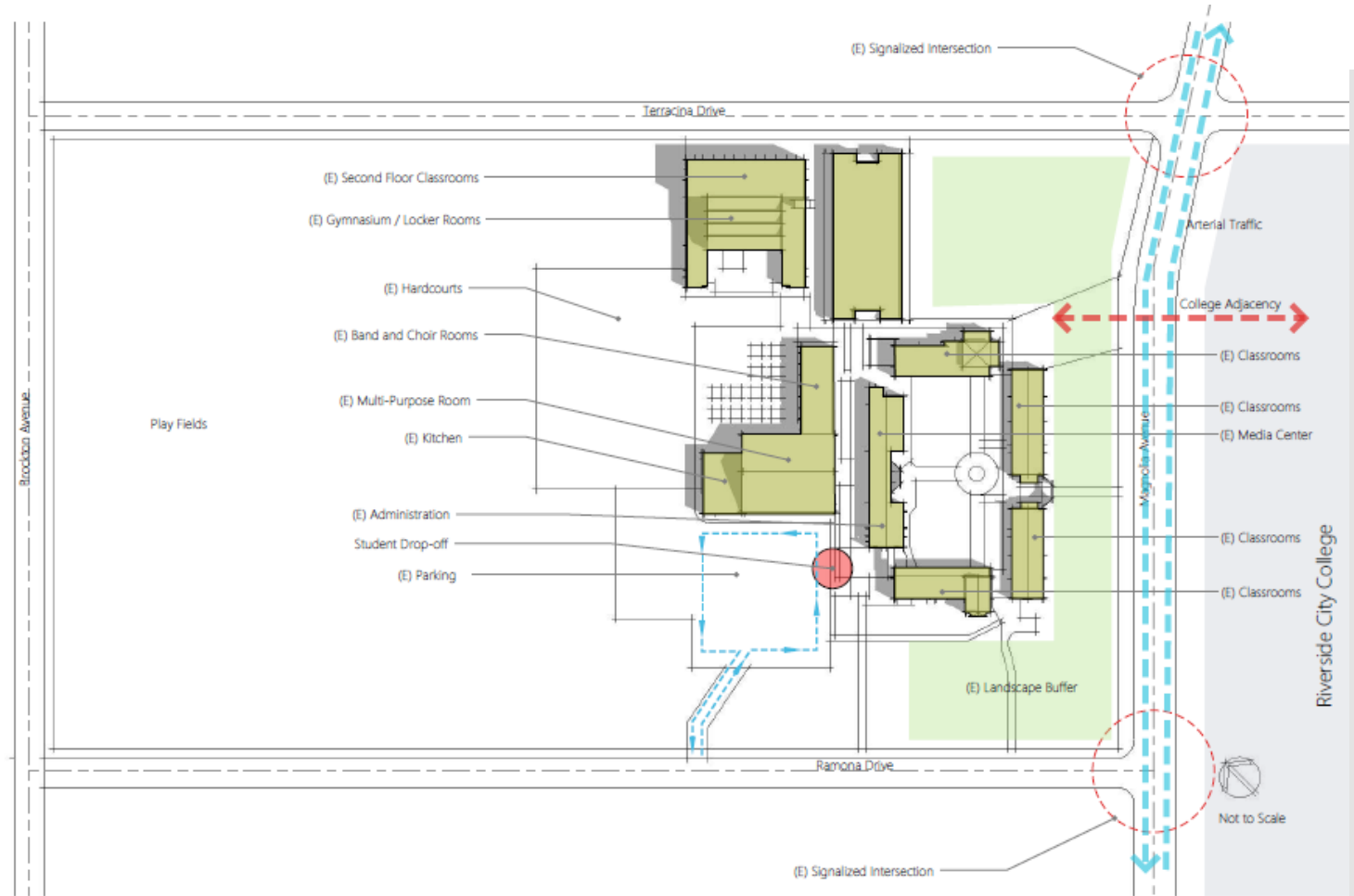

Area 2

Area 1

Central
Middle
School

Riverside
City College

Terracina
Dr

Brockton Ave

Magnolia Ave

Ramona Dr



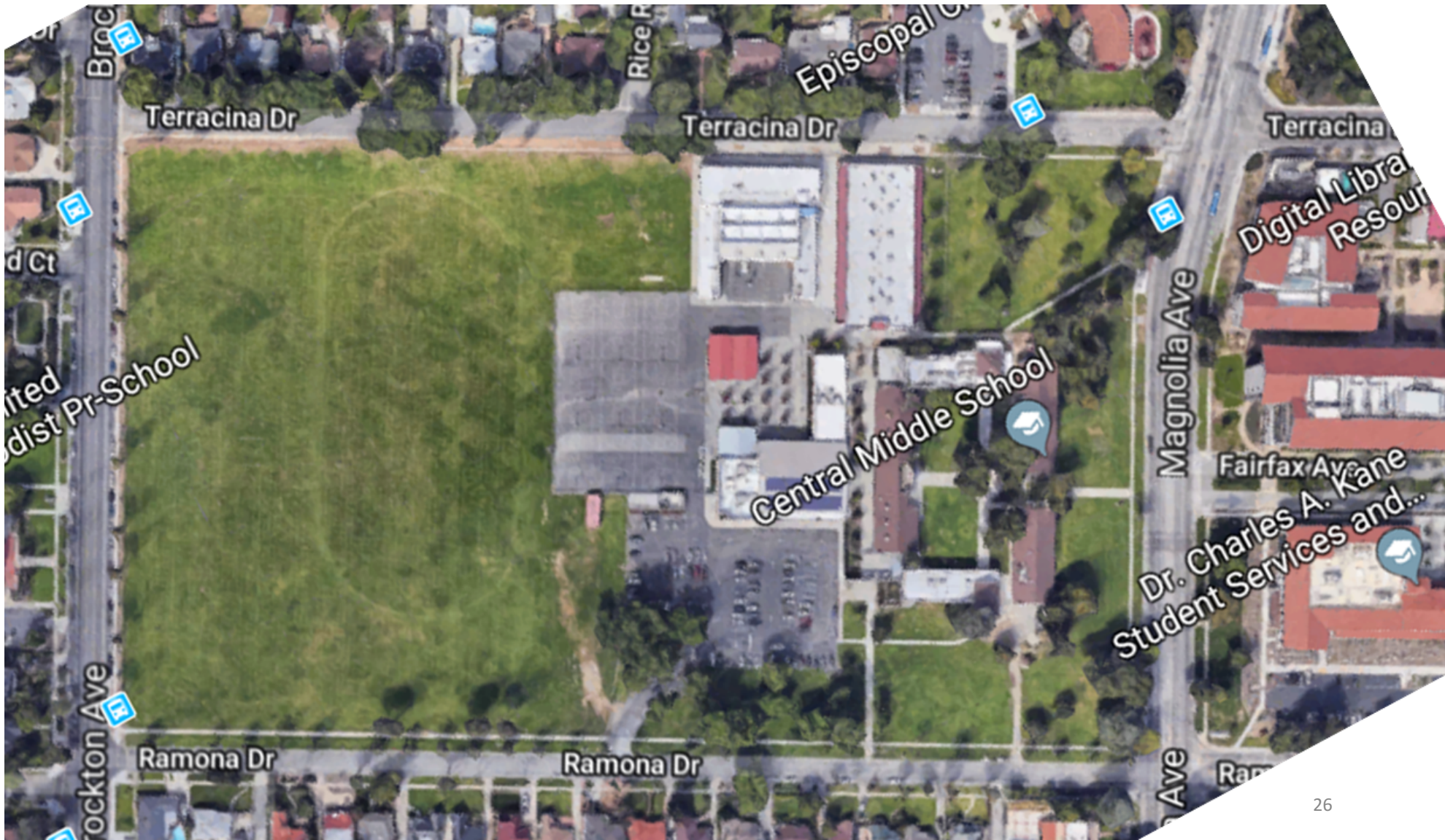

Questions?

